

DB18A DB Trap Sleeve

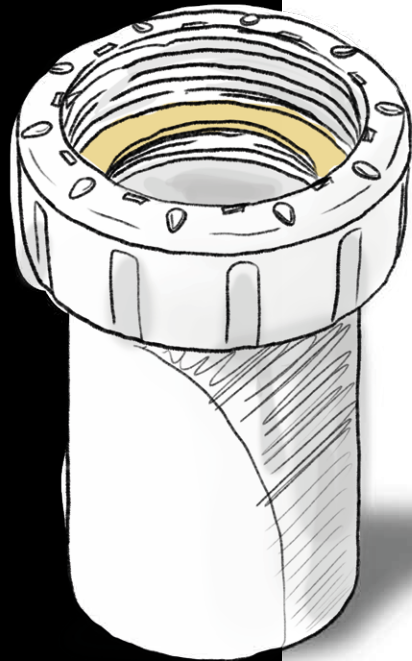

Universal adaptor for 32mm applications

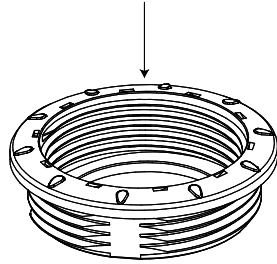

← 40mm inlet

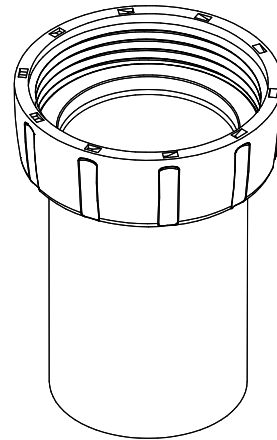

← Adjustable
Top Piece



Dutton Plastics
ENGINEERING
A Division of the Zimco Group (Pty) Ltd.

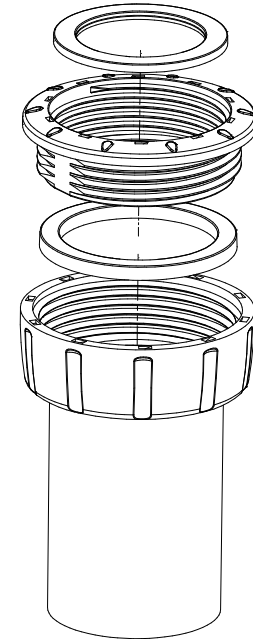

**Extendable Sleeve
with universal adaptor for
32mm applications**



www.duttonplastics.co.za

DB
T R A P S