

Flush Valve Assembly Instructions

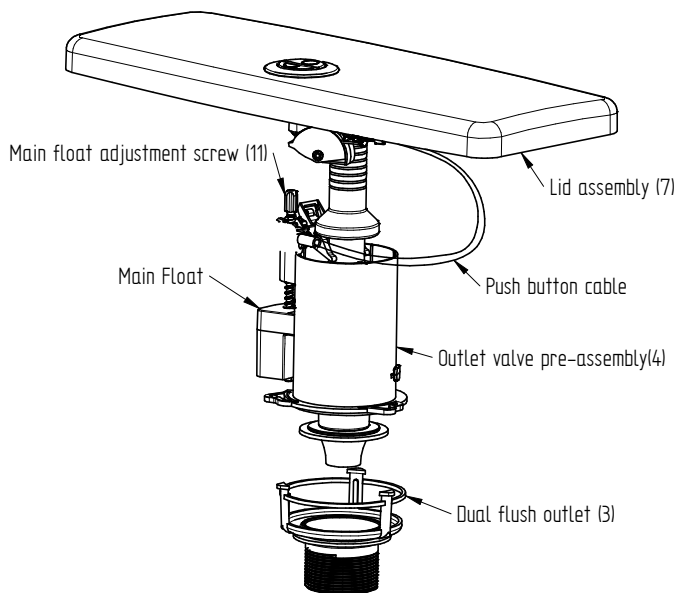

1. Fit push button into lid.
2. Use fastening nut to secure button in place.
3. Fit dual flush outlet into cistern tank.
At the same time connect outlet pipe to toilet bowl (when applicable). (low level application)
4. Clip outlet valve pre-assembly to dual flush outlet.
5. Clip push button mechanism to push button fitted into the lid.
6. By moving the interrupted flush adjustment knob you can increase or decrease the amount of water flushed by up to 1 litre.
7. Fit lid assembly to cistern box.
8. If no full flush is obtained then too much play is in the cable sleeve. Loosen lock nut and adjust screw to take up play and retighten locknut.
9. If no half flush is obtained then not enough play is in the cable sleeve. Loosen lock nut and adjust screw to add play and retighten locknut.
10. If cable has too much tension valve could possibly leak
11. Adjust main full flush float by turning main float screw adjustment to raise or lower the float .
12. Orientate valve so that the cable does not interfere with other parts in the cistern.

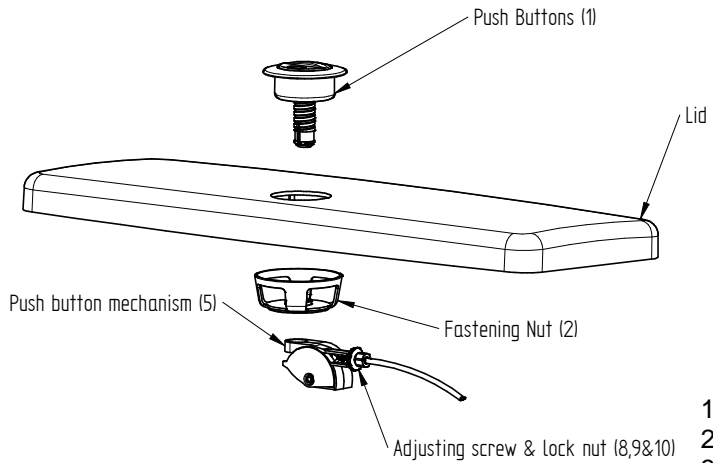
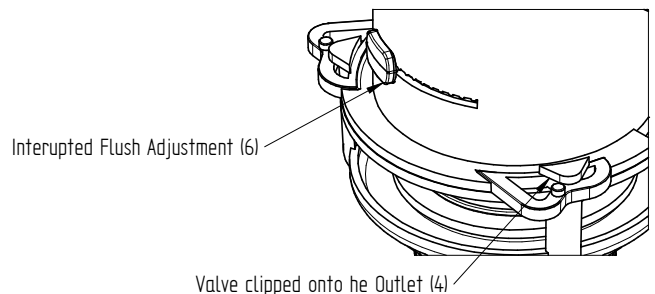
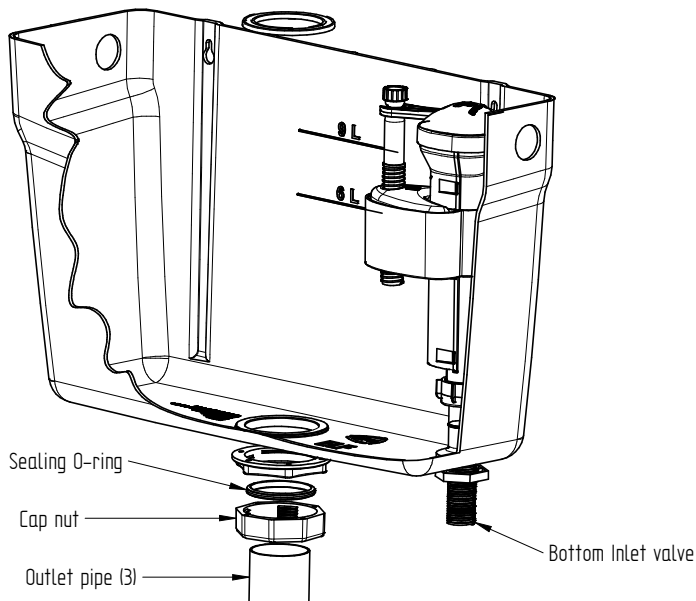

Dutton Plastics
ENGINEERING

Reg. No.1947/025245/07

14 Dienst Street ,Alrode Ext 2, Alberton
PO Box 145092, Bracken Gardens ,1452
Republic of South Africa

Telephone : 27 11 617 5000 Branches
Fax General: 27 11 864 1585 Cape Town: 27 21 712 5454
Fax sales: 27 11 864 2677 Durban: 27 31 701 2816
Fax Accounts: 27 11 864 6993 Website: www.duttonplastics.com
Fax Works: 27 11 864 3202

Guaranteed when installed by a
qualified plumber